

# ***Lunacon '92***

March 20 - 22, 1992

***POCKET PROGRAM***



## Lunacon '92 Policies

**Weapons:** *NO WEAPONS OF ANY KIND ARE PERMITTED.* People with weapons will not be registered. Anyone found to be carrying a weapon during the convention will have his/her membership revoked without compensation. The use of a weapon as part of the Masquerade *must be approved by the Masquerade Director prior to the event.* Going to and from the Masquerade, they must be carried in an opaque carrying case (example: a paper bag).

The Convention Committee defines a weapon as anything that is classified as a weapon under New York State law, any object designed to cause bodily harm, or any replica of such object, and any other object the Committee determines to be dangerous. This includes toy weapons of *all* types. The Committee reserves the right to amend this definition of a weapon, depending upon each individual situation and the associated behavior. We also reserve the right to impound weapons for the duration of the convention. Actions or behavior which interfere with the enjoyment of the convention by other attendees will also result in revocation of membership without compensation. Please remember, if in doubt, *ask* us.

**Costumes:** Please cover any revealing costumes in the public areas of the hotel — the Bar, Lobby/Reception Areas and the Restaurants.

**Smoking:** All function rooms at *Lunacon '92* are non-smoking!!

**Drinking Age:** Please remember that New York State's legal drinking age is 21. The Hotel will be enforcing this law. Alcohol may not be served at *open* parties, and you will be asked to close down if it is. An open party is one that is open to all convention members and is advertised openly at the convention. A closed party is not advertised, is invitational in nature, and runs behind closed doors. **Please note:** All parties *must* be in designated party areas. Parties held in other areas will be closed down.

**Convention Badges:** Please wear your badge. You will need it to get into *all* convention activities.

We regret the severity of the above items, but past incidents have indicated the need for these policies. Please remember to use discretion and be considerate of other hotel guests. Thank you.

# Alphabetical Program Schedule

## **AIDS—Its Impact On and Reflection in Today's Science Fiction and Fantasy**

Westchester Ballroom BC, Saturday 4 pm.

Samuel R. Delany, Patrick Nielsen Hayden, Eleanor Lang, Ellen Key Harris, Scott Edelman

## **The Art of Horror**

Grand Ballroom North, Saturday 11 pm.

Jill Bauman, Alan Clark, Charles Lang, John Betancourt, Adam-Troy Castro, Nicholas Jainschigg

*Immediately following "The Words of Horror". You may not want to go to bed right after these panels.*

## **Art Collecting for Fun and Profit**

Westchester Ballroom A3, Saturday 10 am.

Tony Lewis, Roger Reed, Jane and Howard Frank, N. Taylor Blanchard  
*Collectors, gallery owners, and artists discuss collecting SF/F artwork.*

## **The Art of Anthologizing**

Grand Ballroom North, Sunday 10 am.

Marvin Kaye, Gordon Van Gelder, Richard Gilliam, Robert Legault  
*Assembling successful combinations, writing appropriate introductions.*

## **Art Show Auction**

Grand Ballroom North, Sunday 12 noon.

## **Artist-Agent Relationships**

Westchester Ballroom A1-2, Saturday 2 pm.

Howard Frank, Jane Frank, Jael, Ron Walotsky, Dean Morrissey  
*Artists and agents discussion.*

## **The Base Appeal of Grade Z Movies**

Westchester Ballroom A1-2, Sunday 2 pm.

Vincent Di Fate, Joe De Vito, Linda Bushyager, Chuck Rothman, Gordon Van Gelder

*Why do we keep watching "Attack of the Killer Tomatoes"?*

**Book Exhibit Raffle**

Westchester Ballroom BC, Sunday 2 pm.

*Seth Breidbart and a cast of thousands – what evil fate awaits him this year?...*

**Can Writers Keep Pace With Real World Politics?**

Grand Ballroom North, Friday, 5 pm.

Dean Wesley Smith, Robert Glaub, Dan Hatch, Shariann Lewitt, Alexis Gilliland

*How the fall of the Soviet Union and other recent events affect SF writing.*

**Censorship/Freedom of Information**

Westchester Ballroom BC, Saturday, 3 pm.

Charles Pellegrino, Kathei Logue, Michael Flynn, Barbara Hare, Mercy Van Vlack, A.J. Austin

*Is Big Brother watching your keystrokes?*

**Changing Styles of Cover Art**

Westchester Ballroom A1-2, Sunday, 10 am.

Ron Walotsky, Tom Kidd, Jody Lee, Pat Morrissey, Joe De Vito

*Surrealism to photo-realism – what do the art directors, writers, public want to see on book covers?*

**Computer Art Demonstration and Discussion**

Elm, Saturday, 11 am.

Tom Canty, Kurt Griffith, Barclay Shaw

*Demonstration and discussion of three artists' computer art techniques.*

**Contract Workshop for Writers**

Elm, Saturday, 3 pm.

Jane Jewell, Eleanor Wood, Sharon Jarvis

*Discussion of nitty-gritty aspects of contracts and agents.*

**Convention Budgeting – A Regional Comparison**

Poplar, Saturday, 10 am.

John Lorentz, Mark Olson, Ben Yalow

*How convention policies and priorities affect convention budgets.*

**Costuming and SF Fandom**

Westchester Ballroom, Saturday, 3 pm.

Marty Gear, John Hertz, Rob Himmelsbach, Susan Toker

*Is costuming a vital part of modern SF fandom or wacko fringe group or both?*

### **Creating Gods and Mythology**

Westchester Ballroom BC, Saturday, 1 pm.

Joan Vinge, Greer Gilman, Paul Hazel, Esther Friesner, Mercy Van Vlack  
*Sources for and tips on creating gods, religions, mythologies.*

### **Culture Building**

Westchester Ballroom BC, Friday, 5 pm.

Samuel R. Delany, Donald Kingsbury, Joan Vinge, Josepha Sherman  
*The use of anthropology, archaeology, and linguistics in constructing your society's culture.*

### **David Mattingly Slide Show**

Poplar, Sunday 10 am.

### **Dollars and Sense of Publishing**

Westchester Ballroom A1-2, 11 am.

Tom Doherty, Janna Silverstein, Jim Baen, Ellen Asher, Jim Frenkel,  
Ricia Mainhart

*An examination of the publishing industry.*

### **Donald A. Wolheim Memorial Scholarship Fund Benefit Auction**

Grand Ballroom North, Saturday, 4 pm.

*A fundraiser for the Lunarians' Clarion scholarship – many interesting items have been donated.*

### **Dueling Easels**

Westchester Ballroom A3, Friday, 6 pm.

Geary Gravel, Tom Kidd, Courtney Skinner

*Science Fiction illustration in Action.*

### **The Editors Speak**

Westchester Ballroom A1-2, Sunday, 12 noon.

Janna Silverstein, Jim Frenkel, John Douglas, David Hartwell,

Patrick Nielsen Hayden

*Recommendations on new writers to watch for.*

### **Easy Reading**

Grand Ballroom North, Saturday, 11 am.

Roger MacBride Allen, Charles McGraw, John Lee, Michael Kandel,  
Adam-Troy Castro

*We don't always want heavy meaningful messages – light-hearted works are just as necessary.*

### **A Failure to Extrapolate**

Westchester Ballroom BC, Friday, 4pm.

Michael Flynn, Roger MacBride Allen, Mark Olson, Toni Weisskopf

*Can we create future technology and scenarios that won't be outdated in a few years? Some of the past offenders.*

### **Faking It—Guitar Workshop**

Elm, Saturday, 9 pm.

Marc Glasser

### **Fan Writing—Can It Win Hugos if Not On Twilltone?**

Westchester Ballroom A3, Saturday, 1 pm.

Teresa Nielsen Hayden, Jon Singer, Nancy Atherton, Saul Jaffe, D Potter, Sam Moskowitz

*Will electronic fanac push paper aside? Should Hugo rules be changed?*

### **Fannish Parenting**

Westchester A3, Sunday, 10 am.

Beth Cohen/Topher Cooper, Laurie/Jim Mann, Sue-Rae Rosenfeld/Frank Balazs

*The joys and perils of being a modern fannish parent.*

### **Filk is Poetry**

Westchester Ballroom A3, Friday, 7 pm.

Bill Sutton

*A serious look at filk song lyrics.*

### **Filk One-Shots**

Westchester Ballroom A3, Sunday, 1 pm.

Open Stage (advance sign-up during convention).

### **Filk Concert**

Grand Ballroom North, Saturday, 5 pm.

featuring: Bill and Brenda Sutton; Critical Mass; Rennie Levine; Roberta Rogow; and Singer, Silence and CKA

### **Filk: Evolution From Parody to Sophistication**

Westchester Ballroom A3, Saturday, 2 pm.

John Boardman, Roberta Rogow, Kate Verleger

*How filk songs have progressed from "Bouncing Potatoes" to contemporary folk.*

### **Freelancing—Not for the Faint of Heart!**

Westchester A3, Sunday, 11 am.

Robert Legault, Kij Johnson, Bob Howe, Tom Weber, Nancy Atherton  
*Ins and outs of freelance writing, copyediting, etc.*

### **Funky Hats and Neat Feet: Costuming From Head to Toe**

Poplar, Saturday, 11 am.

Elizabeth Mayberry, Rae Bradbury, Bobby Gear, Denice Girardeau  
*Creative ideas and expert techniques for costume hats, shoes, wigs, boots, hooves, etc.*

### **The Future of Filk**

Westchester Ballroom A3, Sunday 2 pm.

Bill Sutton, Heather Garrett, Carrey Herz  
*What's next in the evolution of filk singing.*

### **The Future of the Prozines**

Westchester BC, Sunday, 1 pm.

Kristine Kathryn Rusch, Dean Wesley Smith, Ian Randal Strock, Charles Ryan, Eric Van

*Where are the professional fiction magazines headed? What changes are forthcoming for Fantasy and Science Fiction, Analog, Asimov's, Aboriginal Science Fiction and the others?*

### **Gripe Session**

Westchester Ballroom BC, Sunday, 4 pm.

*Lunacon '92 concom.*

*Where you get to tell us what you think!*

### **Harmony Workshop**

Elm, Sunday, 12 noon.

Gary McGath, Kate Verleger, Brenda Sutton

*This is a follow-up to the "Voice Workshop" in Poplar, Saturday, 12 noon.*

### **Historical Research for Fantasy/Alternate History**

Grand Ballroom North, Sunday, 2 pm.

Judith Tarr, Greer Gilman, Preston Saul, Eluki Bes Shahar, Barbara Hare  
*How to figure out your historical fantasy/alternate history background.*

### **How Cons Should Treat Their Guests**

Westchester Ballroom A3, Saturday, 12 noon.

Peter Heck, Josepha Sherman, Toni Weisskopf, Vincent Di Fate, Priscilla Olson, Esther Friesner

*What kind of behavior and consideration con guests and program participants would like to see from conventions?*

### **How to Perform at a Concert**

Elm, Saturday, 4 pm.

Bill and Brenda Sutton, Kate Verleger, Lois Mangan.

*Filk concert workshop.*

### **If This Goes On...**

Westchester Ballroom BC, Friday, 9 pm.

John DeChancie, John Douglas, Janice Eisen, Mary Frey, Jim Mann

*Are some of the dire views of the future on target? – are we in real danger of a reactionary right-wing theocracy?*

### **Japanese Animation: Questions and Answers**

Westchester Ballroom A3, Saturday, 12 midnight.

John Carr and Robert Fenelon

### **Jewish Themes in Science Fiction/Fantasy**

Westchester Ballroom A1-2, Sunday, 11 am.

Susan Shwartz, Josepha Sherman, Moshe Feder, Lucy Cohen Schmeidler, David Honigsberg

*What Jewish traditions, folklore, references can be found in Science Fiction and Fantasy?*

### **Jon Singer: Myth or Legend <g>**

Grand Ballroom North, Saturday, 12 noon.

*Fan GOH Jon Singer explains blue roses and we find out why there are Jon Singer Fan Club t-shirts!*

### **Landscape of Fantasy**

Westchester Ballroom BC, Sunday, 12 noon.

Samuel R. Delany, Greer Gilman, Joan Vinge, Esther Friesner, Mary Frey, Marvin Kaye

*Is the map the territory? The importance of location/place setting in fantasy.*



### **Live Role Playing Games—An Introduction**

Westchester Ballroom A3, Friday, 12 midnight.

Peter Cassidy

### **Making and Painting Miniatures**

Poplar, Friday, 7 pm.

Workshop by Lissanne Lake

### **Mars Bound**

Westchester Ballroom BC, Saturday, 12 noon.

Ben Bova, Charles Pellegrino, Joe Bergeron, Dan Hatch, William Engfer

*Who among us will go to Mars, when and how?*

### **Masquerade**

Westchester Ballroom ABC, Saturday, 8:30 pm.

*Convention members dress to the nines!*

### **Masquerade Orientation**

Poplar, Saturday, 4 pm.

Denice Girardeau, Susan De Guardiola, Sue Kulinyi, Lee Orlando

*Mandatory meeting for contestants. Meet Tech Crew and MC, and have number and reporting time assigned.*

### **Masquerade Wrap-Up**

Poplar, Sunday, 2 pm.

Susan De Guardiola, Bobby Gear, Denice Girardeau, Rob Himmelsbach,

Sue Kulinyi, Paul Lehr, Lee Orlando, Susan Toker

*Part I — Masquerade Critique.*

*Part II — Judges Tell All.*

### **Matthew Costello Presentation—New Interactive Nintendo**

Elm, Saturday, 5 pm.

### **Mutant Origami**

Poplar, Sunday, 1 pm.

Morris Keeson

*Demonstration and workshop on new alien lifeforms.*

### **New York Science Fiction Society — the Lunarians, Inc. Open Meeting**

Westchester Ballroom A1-2, Friday, 9 pm.

Members of the Society. All are welcome!

*You, too, could join and run a Lunacon one day.*

**New Games**

Grand Ballroom North, Friday, 6 pm.

David Honigsberg

*A Friendly Ice-Breaker...*

**The New York Review of Science Fiction—A Presentation**

Westchester Ballroom A1-2, Sunday, 3 pm.

**Not for Children Only**

Westchester Ballroom A1-2, Saturday, 1 pm.

Valerie Ontell, Sue-Rae Rosenberg, Bruce Coville, Nancy Hanger,

Susan Rothman

*Children's and young adult SF/F with appeal for all ages.*

**The Novel of the Future**

Westchester Ballroom BC, Saturday, 11 am.

Dean Wesley Smith, Gregory Feeley, John Betancourt, Claire Eddy,

Matthew Costello, Ken Gale

*Are we moving away from printed books? –Graphic novels, multi-media, books on disk...*

**Opening Ceremonies**

Westchester Ballroom BC, Friday, 8 pm.

*Introduction of Guests of Honor, Special Guests and committee and something completely different...*

**Our New Writers—Where Are They Coming From?**

Westchester Ballroom, Sunday, 1 pm.

Lucy Schmeidler, Laurel Winters, Lawrence Schmiel, Marie Parsons,

Mark Andrew Garland

*Is fandom a hidden breeding ground for writers? Is there a manuscript in every drawer? Does a fannish background help or hinder in writing Science Fiction and Fantasy? Or do more Science Fiction and Fantasy writers come from outside?*

**Pagan Sing**

Grand Ballroom North, Saturday, 12 midnight.

Bill and Brenda Sutton

*Celebrating the Equinox.*

### **Parody Writing Workshop**

Poplar, Friday, 9 pm.

Rennie Levine and Roberta Rogow

*Filk lyric writing.*

### **Paul Lehr: GOH Interview, Part II** –by Vincent Di Fate

Westchester Ballroom, Sunday, 11 am.

### **Philip K. Dick Discussion Group**

Elm, Friday, 5 pm.

Eric Van

### **Pinkwater Appreciation**

Elm, Saturday, 6 pm.

Jon Singer and all interested parties

*Readings from and discussion of the works of Daniel Pinkwater.*

### **Professionalism for the Pros**

Westchester Ballroom A3, Saturday, 11 am.

Eleanor Lang, Susan Shwartz, Judith Tarr, Patrick Nielsen Hayden,

Priscilla Olson

*The pros discuss appropriate behavior for neo pros—relating to conventions, fans, and each other.*

### **Re-Creation Costuming**

Poplar, Saturday, 1 pm.

Bobby Gear, Londo Massey, Carol Salemi

*What makes a winning costume, what's been over done, what we'd love to see...*

### **Re-Evaluating the Current Art Show**

Poplar, Saturday, 3 pm.

Joe Mayhew, Gay Ellen Dennett, Stuart C. Hellinger, Mark Olson

*Discussion group on changing bidding and auction policies for major art shows.*

### **Recursive Science Fiction**

Westchester Ballroom A3, Sunday, 3 pm.

Tony Lewis, Hank Davis, Barry Malzberg

*Science Fiction stories incorporating mentions of SF or SF authors—there are more than you'd think.*

### **Reviewing the Reviewers**

Westchester Ballroom BC, Friday, 6 pm.

Gregory Feeley, Janice Eisen, Keith DeCandido, Peter Heck, Adam-Troy Castro, Faye Hazel

*How good (or bad) are current Science Fiction and Fantasy reviews and reviewers?*

### **Road Runner vs. Wile E. Coyote Redux**

Elm, Sunday, 11 am.

Robert Sacks, Michael Flynn, Gary Tesser

*A strange deconstruction of a childhood favorite.*

### **Robot Building**

Grand Ballroom North, Saturday, 9 pm.

Richard Man

*Small robot construction.*

### **Samuel R. Delany GOH Interview** – by Don Keller

Westchester Ballroom BC, Saturday, 2 pm.

### **Science Fiction over the Airwaves**

Grand Ballroom North, Sunday, 3 pm.

Jim Freund, Keith DeCandido, Andrea Lipinsky, John Drew, Lise Eisenberg

*Presentation and discussion by the hosts of local cable TV (The Chronic Rift) and radio (Voice of the Wolf) shows about Science Fiction and Fantasy.*

### **Science Fiction Poetry Association Open Meeting**

Poplar, Saturday, 5 pm.

Chuck Rothman, Susan Rothman

### **Science Fiction/Fantasy Illustration—A Historical View**

Westchester Ballroom A1-2, Saturday, 12 noon.

Paul Lehr, Vincent Di Fate, Roger Reed, Barclay Shaw

*The early illustrators and how the field has grown.*

### **Shakespearean Roots**

Westchester Ballroom BC, Sunday, 10 am.

Alexandra Honigsberg, Greer Gilman, Lawrence Schimel, Greg Feeley

*How much Science Fiction and Fantasy owes to Shakespeare—ideas, themes, style, etc.*

### **Small Press Explosion**

Grand Ballroom North, Saturday, 1 pm.

Kristine Kathryn Rusch, Dean Wesley Smith, Charles Ryan, Scott Edelman, John Betancourt

*What's happening in small press publishing? —is it the wave of the future?*

### **Space Opera—Will There Be Empires and Battles in Space?**

Westchester Ballroom BC, Saturday, 5 pm.

P. M. Griffin, Robert Glaub, Ben Bova, Susan Schwartz, Kenneth Von Gunden

*Will we have federations or empires? Are "Doc Smith" style battles going to happen?*

### **Split Personalities**

Grand Ballroom North, Saturday, 3 pm.

Kristine Kathryn Rusch, Josepha Sherman, Darrell Schweitzer, Dean Wesley Smith

*Writer/editors — how doing one activity affects the other.*

### **Star Trek: The Future**

Westchester Ballroom A3, Saturday, 4 pm.

Joan Winston, Tony Lewis, Pam Fremon

*What will Star Trek be without Gene Roddenberry? Is this the "third season" of TNG? And what about ST: Deep Space Nine?*

### **Starship Libraries**

Grand Ballroom North, Saturday, 8 pm.

Janice Eisen, John Douglas, Joe Mayhew, Bob Howe, John DeChancie

*What 10 books would you select to take on an interstellar voyage?*

### **Teaching Science Fiction**

Grand Ballroom North, Saturday, 10 am.

Samuel R. Delany, Nicholas Jainschigg, Charles Rothman, Susan Rothman

### **To "Tuckerize" or Be "Tuckerized"**

Westchester Ballroom A3, Sunday, 12 noon.

Michael Flynn, Linda Bushyager, Ben Yalow, Hank Davis, Jack Chalker

*What is "Tuckerizing"?, some famous examples, and how do the honorees/victims feel about it?*

### **Today's Comics – More than the Price Has Changed**

Westchester Ballroom A1-2, Saturday, 3 pm.

Ron Goulart, Julius Schwartz, Ken Gale, Scott Edelman, Charles Lang,  
Mery Van Vlack

*The evolution of the comicbook – code of standards, modern concerns, etc.*

### **Uncle Jon's Bedtime Stories**

Westchester Ballroom A1-2, Friday, 11 pm.

Readings by Jon Singer

### **Unearthing Atlantis**

Westchester Ballroom A3, Friday, 4 pm.

Charles Pellegrino

*Presentation and slide show on underwater research.*

### **Voice Workshop**

Poplar, Saturday, 12 noon.

Bill and Brenda Sutton

*There is also a "Harmony Workshop" follow-up, in Elm, Sunday, 12 noon.*

### **Weirding Out Your Friends**

Westchester Ballroom A3, Friday, 5 pm.

Moshe Feder, Hank Davis, Jon Singer, Tom Weber, Morris Keeson

*Fans share their bizarre musical interests.*

### **Where Are the Readers of Tomorrow?**

Westchester Ballroom BC, Sunday, 3 pm.

Alexis Gilliland, Kristine Kathryn Rusch, Lise Eisenberg, Jon Singer,  
Samuel R. Delany

*Will the TV/computer-raised generations still read books? – what will happen  
to fandom as we know it?*

### **The Words of Horror**

Grand Ballroom North, Saturday, 10 pm.

Gordon Van Gelder, Darrell Schweitzer, John Betancourt, Marvin Kaye,  
C.H. Sherman

*Followed immediately by "The Art of Horror." You may not want to go to bed right  
after these panels.*

### World Fantasy Convention – What's Next?

Westchester Ballroom A3, Saturday, 5 pm.

Ed Kramer, Richard Gilliam, David Hartwell, Stuart C. Hellinger

*A look at the '92 World Fantasy Convention in Georgia and future possibilities.*

### Writers' Workshops – Do They Work for Everyone?

Westchester Ballroom A1-2, Saturday, 10 am.

Alexandra Honigsberg, Sue Rothman, Steven G. DesJardins, Scott Edelman,

Pam Fremon, Laurie Mann

*The pros and cons of workshopping for new writers.*

## Readings

Elm		Poplar	
<i>Day and Time</i>	<i>Reader</i>	<i>Day and Time</i>	<i>Reader</i>
<i>Fri, 4 pm</i>	Bruce Coville	<i>Sun, 11 am</i>	Judith Tarr
<i>Sat, 10 am</i>	Eluki Bes Shahrar	<i>Sun, 11:30 am</i>	Kristine Kathryn Rusch
<i>Sat, Noon</i>	Marvin Kaye	<i>Sun, Noon</i>	Scott Edelman
<i>Sat, 12:30 pm</i>	C.H. Sherman	<i>Sun, 12:30 pm</i>	Ben Bova
<i>Sun, 1 pm</i>	Josepha Sherman	<i>tba</i>	<i>tba</i>
<i>Sun, 1:30 pm</i>	Susan Shwartz	<i>tba</i>	<i>tba</i>

*Additional readings to be scheduled. Please check the Convention Newsletter.*



<b>Friday</b>	<b>Westchester Ballroom BC</b>	<b>Grand Ballroom North</b>	<b>Westchester Ballroom A1-2</b>
<b>4-5 pm</b>	<b>A Failure to Extrapolate</b>		
<b>5-6 pm</b>	<b>Culture Building</b>	<b>Can Writers Keep Pace With Real World Politics?</b>	
<b>6-7 pm</b>	<b>Reviewing The Reviewers</b>	<b>New Games</b>	
<b>7-8 pm</b>			
<b>8-9 pm</b>	<b>Opening Ceremonies</b>		
<b>9-10 pm</b>	<b>If This Goes On...</b>	<b>Regency Dancing</b>	<b>New York Science Fiction Society – The Lunarians, Inc. Open Meeting</b>
<b>10-11 pm</b>			
<b>11 pm-Midnight</b>			<b>Uncle Jon's Bedtime Stories</b>
<b>Midnight-1 am</b>			



<b>Westchester Ballroom A3</b>	<b>Poplar</b>	<b>Elm</b>
<b>Unearthing Atlantis</b>	<b>Video</b>  <u>Green Hornet</u> (serial)	<b>Various Readings</b>  (one-half hour each – readers to be announced)
<b>Weirding Out Your Friends</b>		<b>Philip K. Dick Discussion Group</b>
<b>Dueling Easels</b>		
<b>Filk Is Poetry</b>	<b>Making and Painting Miniatures</b>	
	<b>Parody Writing Workshop</b>	
	<b>Filking I</b>	<b>Filking II</b>
<b>Live Role Playing Games – An Introduction</b>		

<b>Saturday</b>	<b>Westchester Ballroom BC</b>	<b>Grand Ballroom North</b>	<b>Westchester Ballroom A1-2</b>
<b>10-11 am</b>		Teaching Science Fiction	Writers' Workshops – Do They Work for Everyone?
<b>11 am- Noon</b>	The Novel of the Future	Easy Reading	Dollars and Sense of Publishing
<b>Noon- 1 pm</b>	Mars Bound	Jon Singer: Myth or Legend? <g>	Science Fiction and Fantasy Illustration – A Historical View
<b>1-2 pm</b>	Creating Gods and Mythology	Small Press Explosion	Not for Children Only
<b>2-3 pm</b>	Samuel R. Delany: GOH Interview – by Don Keller		Artist-Agent Relationships
<b>3-4 pm</b>	Censorship/ Freedom of Information	Split Personalities	Today's Comics – More than the Price Has Changed
<b>4-5 pm</b>	AIDS – Its Impact On and Reflection in Today's Science Fiction and Fantasy	Donald A. Wollheim Memorial Scholarship Fund Benefit Auction	Saturday Afternoon at the Movies <i>(continuing until 6 pm)</i>

<b>Westchester Ballroom A3</b>	<b>Poplar</b>	<b>Elm</b>
<b>Art Collecting for Fun and Profit</b>	<b>Convention Budgeting – A Regional Comparison</b>	<b>Various Readings</b>  <i>(one-half hour each – readers to be announced)</i>
<b>Professionalism for the Pros</b>	<b>Funky Hats and Neat Feet: Costuming From Head to Toe</b>	<b>Computer Art Demonstration and Discussion</b>
<b>How Cons Should Treat Their Guests</b>	<b>Voice Workshop</b>	<b>Various Readings</b>  <i>(one-half hour each – readers to be announced)</i>
<b>Fan Writing – Can It Win Hugos If It's Not On Twilltone?</b>	<b>Re-Creation Costuming</b>	
<b>Filk: Evolution From Parody to Sophistication</b>		
<b>Costuming and SF Fandom</b>	<b>Re-Evaluating the Current Convention Art Show</b>	<b>Contract Workshop for Writers</b>
<b>Star Trek: The Future</b>	<b>Masquerade Orientation</b>  <i>(Mandatory meeting for contestants. Meet Tech Crew and MC and have number and reporting time assigned.)</i>	<b>How to Perform at a Concert</b>

<b>Saturday</b>	<b>Westchester Ballroom BC</b>	<b>Grand Ballroom North</b>	<b>Westchester Ballroom A1-2</b>
<b>5-6 pm</b>	Space Opera – Will There Be Empires and Battles in Space?	Filk Concert	Saturday Afternoon at the Movies  <i>(continued from 4 pm)</i>
<b>6-7 pm</b>	Masquerade Set-Up		Masquerade Set-Up
<b>7-8 pm</b>	<i>(room closed until 8 pm)</i>		<i>(room closed until 8 pm)</i>
<b>8-9 pm</b>	Masquerade starts 8:30 pm	Starship Libraries	Masquerade starts 8:30 pm
<b>9-10 pm</b>	Intermission – featuring Magician R.J. Lewis	Robot Building	Intermission – featuring Magician R.J. Lewis
<b>10-11 pm</b>	Masquerade continues	The Words of Horror	Masquerade continues
<b>11 pm- Midnight</b>		The Art of Horror	
<b>Midnight- 1 am</b>		Pagan Sing	

<b>Westchester Ballroom A3</b>	<b>Poplar</b>	<b>Elm</b>
<b>World Fantasy Convention –What's Next?</b>	<b>Science Fiction Poetry Association Open Meeting</b>	<b>Matthew Costello Presentation – New Interactive Nintendo</b>
<b>Masquerade Set-Up</b>  <i>(room closed until 8 pm)</i>	<b>Video</b>  <u>Radar Men From the Moon</u> (serial)	<b>Pinkwater Appreciation</b>
<b>Masquerade starts 8:30 pm</b>		
<b>Intermission – featuring Magician R.J. Lewis</b>		<b>Faking It – Guitar Workshop</b>
<b>Masquerade continues</b>	<b>Filking I</b>	<b>Filking II</b>
<b>Japanese Animation: Questions and Answers</b>		



# THE RYE TOWN HILTON

## Floor Plan

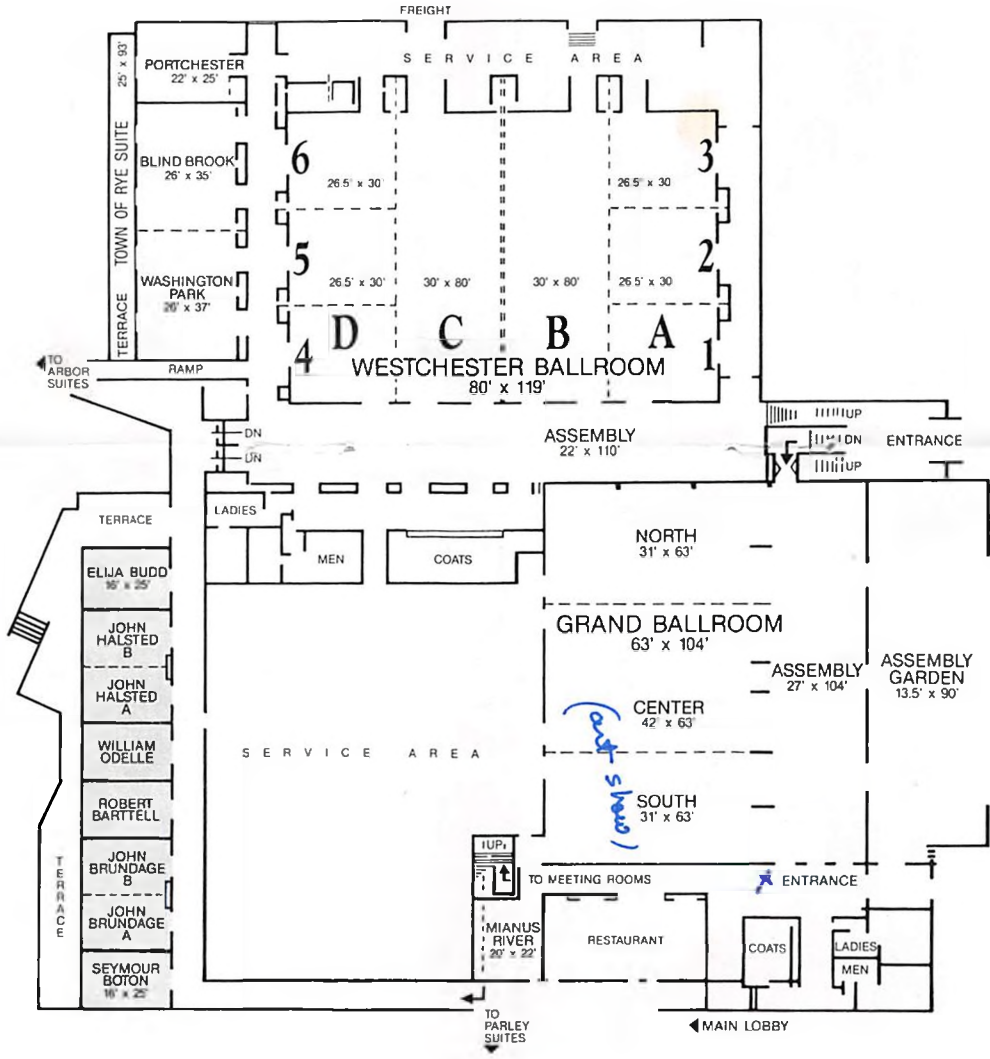

<b>Sunday</b>	<b>Westchester Ballroom BC</b>	<b>Grand Ballroom North</b>	<b>Westchester Ballroom A1-2</b>
<b>10-11 am</b>	<b>Shakespearean Roots</b>	<b>The Art of Anthologizing</b>	<b>Changing Styles of Cover Art</b>
<b>11 am-Noon</b>	<b>Paul Lehr: GOH Interview, Part II – by Vincent Di Fate</b>		<b>Jewish Themes in Science Fiction/Fantasy</b>
<b>Noon-1 pm</b>	<b>Landscape of Fantasy</b>	<b>Art Show Auction</b>	<b>The Editors Speak</b>
<b>1-2 pm</b>	<b>The Future of the Prozines</b>		<b>Our New Writers – Where Are They Coming From?</b>
<b>2-3 pm</b>	<b>Book Exhibit Raffle</b>	<b>Historical Research for Fantasy/ Alternate History</b>	<b>The Base Appeal of Grade Z Movies</b>
<b>3-4 pm</b>	<b>Where Are the Readers of Tomorrow?</b>	<b>Science Fiction over the Airwaves</b>	<b>The New York Review of Science Fiction – A Presentation</b>
<b>4-5 pm</b>	<b>Gripe Session</b>		

<b>Westchester Ballroom A3</b>	<b>Poplar</b>	<b>Elm</b>
<b>Fannish Parenting</b>	<b>David Mattingly Slide Show</b>	
<b>Freelancing – Not for the Faint of Heart!</b>	<b>Various Readings</b> <i>(one-half hour each – readers to be announced)</i>	<b>Roadrunner vs. Wile E. Coyote Redux</b>
<b>To "Tuckerize" or Be "Tuckerized"</b>		<b>Harmony Workshop</b>
<b>Filk One-Shots</b> <i>Open Stage (with advance sign-up during convention)</i>	<b>Mutant Origami</b>	<b>Various Readings</b> <i>(one-half hour each – readers to be announced)</i>
<b>The Future of Filk</b>	<b>Masquerade Wrap-Up</b>	
<b>Recursive Science Fiction</b>		



## Lunacon '92 would like to thank

Roger MacBride	Allen	Gay Ellen Dennett
Ellen Asher		Stephen G.
Nancy Atherton		DesJardins
A. J. Austin		Joseph De Vito
Jim Baen		Vincent Di Fate
Frank Balazs		Thomas Doherty
Jill Bauman		John Douglas
Joe Bergeron		John Drew
Eluki Bes Shaha		Claire Eddy
John Betancourt		Scott Edelman
Michael Betancourt		Bob Eggleton
N. Taylor Blanchard		Janice Eisen
John Boardman		Lise Eisenberg
Ben Bova		William Engfer
Rae Bradbury		Moshe Feder
Bill Brown		Greg Feeley
Linda Bushyager		Robert Fenelon
Thomas Canty		Michael F. Flynn
John Carr		Howard Frank
Adam-Troy Castro		Jane Frank
Jack L. Chalker		Pam Fremon
Bryan Cholfin		Jim Frenkel
Beth Cohen		Jim Freund
Judith Conly		Mary Frey
Topher Cooper		Esther Friesner
Matthew J. Costello		Ken Gale
Bruce Coville		Mark Andrew Garland
Hank Davis		Heather Garrett
Keith DeCandido		Bobby Gear
John DeChancie		Marty Gear
Susan De Guardiola		Richard H. Gilliam
		Alexis Gilliland
		Greer Gilman
		Laura Anne Gilman
		Denice Giradeau
		Marc Glasser
		Robert Glaub
		Ron Goulart
		Geary Gravel
		P. M. Griffin
		Kurt Griffith
		Nancy C. Hanger
		Barbara A. Hare
		Ellen Key Harris
		David G. Hartwell
		Dan Hatch
		Teresa Nielsen
		Hayden
		Patrick Nielsen
		Hayden
		Faye Hazel
		Paul Hazel
		Peter Heck
		Stuart C. Hellinger
		John Hertz
		Carrey Herz
		Rob Himmelsbach
		Alexandra
		Honigsberg
		David Honisberg
		Robert Howe
		Jaell

## the following program participants:

Saul Jaffe  
Nicholas Jainschigg  
Sharon Jarvis  
Jane Jewell  
Kij Johnson  
Michael Kandel  
Rick Katze  
Marvin Kaye  
Morris Keeson  
Don Keller  
Thomas Kidd  
Donald Kingsbury  
Eric Kramer  
Sue Kulinyi  
Lissanne Lake  
Charles Lang  
Eleanor Lang  
Jody A. Lee  
John Lee  
Robert Legault  
Rennie Levine  
R.J. Lewis  
Tony Lewis  
Shariann Lewitt  
Andrea Lipinsky  
Kathei Logue  
John Lorentz  
Spencer Love  
Gary McGath  
Charles G. McGraw  
Ricia Mainhardt

Barry N. Malzberg  
Richard Man  
Lois Mangan  
Laurie Mann  
Londo Massey  
David Mattingly  
Elizabeth Mayberry  
Joe Mayhew  
Pat Morrissey  
Sam Moskowitz  
Mark Olson  
Priscilla Olson  
Valerie Ontell  
John Ordovery  
Lee Orlando  
Marie Parsons  
Charles Pellegrino  
D. Potter  
Roger Reed  
Roberta Rogow  
Sue-Rae Rosenfeld  
Chuck Rothman  
Susan N. Rothman  
Charles C. Ryan  
Robert Sacks  
Carol Salemi  
Preston Saul  
Lawrence Schimel  
Lucy Cohen  
Schmeidler  
Julius Schwartz

Darrell Schweitzer  
Barclay Shaw  
C. H. Sherman  
Josepha Sherman  
Susan Shwartz  
Janna Silverstein  
Courtney Skinner  
Dean Wesley Smith  
Ian Randal Strock  
Walter Stutzman  
Judith Tarr  
Gary Tesser  
Susan Toker  
Eric Van  
Gordon Van Gelder  
Mercy Van Vlack  
Kate Verleger  
Joan Vinge  
Kenneth Von Gunden  
Ron Walotsky  
Tom Weber  
Toni Weisskopf  
Laurel Winter  
Joan Winston  
Eleanor Wood  
Benjamin Yalow



## Art Show (Grand Ballroom Center/South)

The *Lunacon* Art Show has become one of the highest quality Science Fiction Convention Art Shows in the country. Our Art Show and Print Shop are located in the Grand Ballroom Center and South. The finest works of many amateurs and professionals are on display. There are approximately 110 panels of original artwork, 12 tables for 3-D art, and a larger Print Shop where multiple copies of reproductions are for sale.

Before bidding for art, either at the auction or by written bid, or making a purchase at the Print Shop, *you must have a bidder number*. To do this, fill out a bidder registration form at the Art Show Desk. When you are given your bidder number, you are given a copy of the rules for the Art Show and Print Shop.

Sales of original art will be by written bid only. Bidding will end at 11 am Sunday and those pieces receiving seven (7) written bid will go to our voice auction starting at Noon Sunday in the Grand Ballroom North.

Our Print Shop will have a large display area for the various SF art reproductions that will be entered. These are usually less expensive copies of some of the pieces of original art that are for sale in the Art Show, pieces marked "NFS" (not for sale) or pieces by other artists who choose not to display their original works. All prints will be for sale at fixed prices. Print Shop purchases must be taken away upon purchase. The Print Shop will be open the same hours as the Art Show.

Cash, checks (sorry, we cannot accept any out of country checks), MasterCard and Visa will be accepted for all purchases.

**Photography.** To protect the artist's rights, **NO** photography will be allowed in the Art Show except for official convention photographs and supervised press photography. You may not bring a camera into the Art Show unless it is sealed in a bag.

**Awards.** All convention attendees are eligible to vote for the *Best Professional Artist* and *Best Amateur Artist* awards. Ballots are available at the Art Show Desk and must be turned in by 8 pm on Saturday. There will be other awards that will be chosen by a panel of judges.

**Art Show and Print Shop Hours.** The Art Show Hours are as follows:

<i>Friday</i>	8 pm - 10 pm
<i>Saturday</i>	10 am - 10 pm
<i>Sunday</i>	9 am - 11 am Open 11 am - 12:30 pm Closed Noon - 2 pm Auction (Grand Ballroom North) 12:30 pm - 3 pm Art Show Sales and Print Shop Open

## Autographing

Autographing by various Program Participants is in the assembly area outside of the Grand Ballroom.

## Child Care

All children *must* be accompanied by an adult in order to purchase a membership, and *all* children must be registered with the convention.

All children twelve and under will have the following additional information listed on the back of their badge: the parent's (or responsible adult's) name and hotel room number (if applicable). These children must, at all times, be under the supervision of an adult or in the *Lunacon* Child Care area. If a young child is found unattended, we will bring that child to the Child Care area, and the child's parent will be billed for the time that child is in our Child Care area.

We are aware that many children in the 6 to 12 year old range are capable of independent activity. As long as they are not causing problems, they do not have to be under adult supervision. However, if they are not capable of such independent activity (and this capability is defined by the Convention Committee), they must be under adult supervision or in the Child Care area.

We have expanded the number of hours that the convention will provide Child Care and have once again contracted with a professional service for this purpose. The cost is \$2.50 per hour, with a maximum of \$32.50 charged for any

child. Children will be provided with supervision, juice and other healthy snacks, but **not** meals. Parents are asked to provide toys, games, diapers, etc.

**PLEASE NOTE:** We have hired a limited number of professionals for this service, therefore we might not be able to accommodate your needs if you did not notify us in advance of your interest. We are sorry for any inconvenience.

Child Care will be available during the following hours:

<i>Friday</i>	3 pm to 11 pm
<i>Saturday</i>	10 am to Midnight
<i>Sunday</i>	10 am to 4 pm

Child Care tickets will be sold in the Convention Office. The Child Care room is the Island Suite on the fifth floor of the hotel.

## Book Exhibit and Raffle (Maple Suite)

Once again this year, our Book Exhibit will feature an assortment of books by prominent SF and Fantasy authors, as well as free magazine subscriptions, role-playing games and computer software, all donated by their respective publishers. All will be raffled off on Sunday.

The Book Exhibit will be open:

<i>Friday</i>	4 pm - 10 pm
<i>Saturday</i>	10 am - 10 pm
<i>Sunday</i>	9 am - 12:30 pm

The Book Exhibit Raffle will be held starting at 2 pm Sunday in Westchester Ballrooms B and C. Join the chorus of those wanting to "*Kill Seth!*"

Raffle tickets are 50¢ each, 5 for \$2 or 250 for \$100, and will be sold at the Book Exhibit and at Convention Sales. Surplus funds from the Raffle will be added to the Lunarians' **Donald A. Wollheim Memorial Scholarship Fund**.

## Dealers' Room (Town of Rye Suite and Westchester Ballroom D)

<i>Friday</i>	5 pm - 8 pm
<i>Saturday</i>	10 am - 6 pm
<i>Sunday</i>	10 am - 3 pm

## Fanzine Lounge (Elija Budd Room)

Fanzines are amateur publications produced by Science Fiction, Fantasy and Media fans to talk about our hobbies — books, games, media — and life in general for other members of the fannish community. Fans do them for the joy of writing and drawing, and send them to each other, or to anyone they think might enjoy them. One way of showing interest, and helping ensure that you receive future issues, is by writing back a letter of comment (or "loc"). Fanzines have been around for some 60 years - before there were SF conventions and long before there were computer nets - and during that time they have been produced by a range of methods: hektograph, spirit duplicator (ditto), mimeograph, offset, photocopier and desktop publishing.

If you already know about fanzines, you'll find the Fanzine Lounge (located in the Elija Budd Room) a cozy place for hanging out, reading fanzines (and discovering some you may never have seen before) and socializing with like-minded fans, artists and writers; it's also a place where members of amateur press associations (or apas) can get together during the Convention.

Fanzines of the past and present are on display, including (we hope) some by our Fan Guest of Honor, Jon Singer. Discover why we selected him to be our Fan Guest of Honor (and wonder about why he's allowed to run around loose).

If fanzines are new to you, this is your chance to see what they're about, and to talk to people who have been contributing to or editing them.

Whatever your background, you're invited to the one-shot (that is, a fanzine for the occasion) we'll be producing at the convention. This is your chance to tell that great story about your uncle's pet orangutan, or how you almost got married

to a perfect stranger who spoke only Guarani, or about your favorite used bookstore, or why you love — or hate — old game shows, baseball or paprika.

So come on by, pull up a chair, and see what fanzines are all about. We'll tell you how we do it, and maybe even why. No promises.

The Fanzine Lounge will be open for your pleasure and curiosity during the following hours:

<i>Friday</i>	3 pm - 7 pm
<i>Saturday</i>	10 am - 5:30 pm
	8 pm - 11 pm
<i>Sunday</i>	10 am - 2 pm

## Film and Video Program

No convention would be complete without a film program, and *Lunacon '92* is no exception. This year, however, much of the program is video-based. It should still prove to be a unique and enjoyable viewing experience.

Screening during *Saturday Afternoon at the Movies*:

**Radar Men From the Moon** (*first episode of serial, 16mm*) A sneak-preview of a complete serial.

**The Bugs Bunny/Road Runner Movie** (*16mm*): In this full length feature film, Bugs, now living in semi-retirement in his mansion, amidst memorabilia and carrots, reminisces about his experiences with friends and foes alike through the use of vintage cartoons.

Also showing this weekend:

**Green Hornet** (*serial, on video*): Crusading publisher Britt Reid finds out that a crooked insurance ring has profited from accidents at a tunnel-construction site. He also uncovers a flying school scandal and an auto-stealing ring. In addition, he comes across a contraband munitions ring and a transportation racket! In the guise of the Green Hornet and accompanied by his faithful servant, Kato,

Reid pursues each of these gangs. He soon discovers that all of the gangs are masterminded by one criminal genius.

**Radar Men From the Moon** (*serial, on video*): Commando Cody flies to the Moon, discovering a hidden city ruled by Retik, who attempts to conquer the Earth.

Check the Program Grid for locations and times of these shows.

Also, in the Poplar room, on Saturday and Sunday from 8 am until 9:30 am, we will be presenting "Lunacon Morning Cartoons". These will feature Underdog, Courageous Cat (and Minute Mouse, of course!), and an early Jay Ward creation, Crusader Rabbit!

## Gaming (William Odelle and Robert Bartelle Rooms)

There will be two types of gaming available.

**Open Gaming** will run 24 hours a day starting around 5:00 PM Friday through 4:00 PM Sunday.

**RPGA Gaming** will have multiple one and two round tournaments throughout the weekend, with prizes awarded to the winners. Sign-up sheets will be available in the gaming room.

Please check the convention newsletter for a listing of which type of gaming is in which room.

## Hospitality Suite (The Parley Suites)

The Hospitality Suite is the convention sponsored party where *Lunacon* attendees can meet, chat and relax. The Parley Suites are a set of three interconnected rooms located on the 4th floor and are open as follows:



<i>Friday</i>	8:30 pm - 4 am
<i>Saturday</i>	11 am - 7 pm 8:30 pm - 4 am
<i>Sunday</i>	11 am - ?

## Japanese Animation Video Room Schedule (John Brundage Room)

### *Friday*

7 pm	Opening Titles (Narrated)
7:30 pm	Star Blazers compiler "The Quest For Iskander" (Dubbed into English)
9 pm	Black Magic M-66 parody "Super Mario Brothers" (Subtitled)
10 pm	Little Nemo In Slumberland (Dubbed into English)
Midnight	The Name of the Wind Is Amnesia (Subtitled)
1:30 am	The Guyver (English, Live Action)
3 am	Room Closes, Good Night!

### *Saturday*

10 am	Star Blazers compiler "The Comet Empire" (Dubbed into English)
Noon	C.B. World of Go Nagai (Devilman parody) (Narrated)
2:15 pm	Lunchbreak! (Room Closed)
3 pm	Nadia Of The Mysterious Seas (compiler part 1) (Narrated)
6 pm	Fuma no Kojiro II (#1-6) (Narrated)
9 pm	Dinner Break (Room Closed)
10 pm	Mobile Suit GUNdam 0083 Stardust Memories 1-4 (Subtitled)
Midnight	Orange Road "Tap Gun" Subtitled
12:30 am	3X3 Eyes #1 (Subtitled)
1 am	Godzilla Vs King Ghidrah Subtitled, Live Action)
2:45 am	Room Closes, Good Night!

### *Sunday*

10 am	NADIA #1 (Dubbed into English)
10:30 am	Nadia Compiler part 2 (Narrated)
1:30 pm	Assemble Insert (Subtitled)
2:30 pm	Star Blazers Compiler "The Bollar Wars" (Dubbed into English)
4 pm	Room Closes, Go Home!

## **Member Services (Westchester Ballroom Assembly)**

Attendees who need help or information at the convention will find it available at the Member Services Desk in the Assembly area in front of the Westchester Ballroom. Member Services is the place to leave messages on our Message Board, leave copy for our newsletter, check the Metro-North train schedules, or coordinate handicapped services. You will also be able to find the absolute latest updates on programming changes - even those too late to make the daily newsletter. Member Services will also serve as an ombudsman or intermediary for attendees who need assistance in their dealings with the hotel. Member Service will be open:

<i>Friday</i>	3 pm - 9 pm
<i>Saturday</i>	9 am - 6 pm
<i>Sunday</i>	9:30 am - 2 pm

When Member Service is not open, please ask for help in the Convention Office.

## **Newsletter**

*Loonie Times*, the Convention Newsletter will have the latest program changes, other information of note and a listing of all the open parties we know about. Items for the newsletter may be left at Member Services or the Convention Office. Copies will be available at locations throughout the convention.

## Office (The Larch Birch Suite)

The *Lunacon* Office is the main operational focal point of the convention. This is where you can leave copy for our newsletter, retrieve lost items, connect with a Committee Member, purchase Child Care tickets, and so on. You will also be sent there if your particular problem cannot be solved at Member Services. It will be open most hours of the convention.

## Registration (Main Floor Coat Room near the Grand Ballroom)

Registration is located in the Main Floor Coat Room near the Grand Ballroom and is open:

<i>Friday</i>	3 pm - 9 pm
<i>Saturday</i>	9 am - 6 pm
<i>Sunday</i>	9:30 am - 1 pm?

**Lost Badges.** If you lose your badge during the convention:

1. Check with Member Services and/or the Convention Office to see if it has been turned in there.
2. If it has not been turned in at either location, check with Registration. If the badge was not turned in there, a replacement will cost you \$10.00.

There is **no** lost badge replacement on Friday. ***Your first opportunity to purchase a replacement badge will be Saturday at 9:00 am at Registration.*** This means that if you lose your badge on Friday, you will not be able to attend any convention activities on Friday night.

3. If you lose your badge a second time, you will be charged \$15.00 for your final replacement badge. ***You will not receive a third replacement badge.***

If you find a lost badge, please turn it in. You could make someone very happy.

## Sales (Westchester Ballroom Assembly)

For those who would like to purchase a *Lunacon '92* t-shirt, Book Exhibit Raffle tickets, or various t-shirts and jerseys from past *Lunacons* (if you somehow missed buying them back then, here's another chance for you to get them), and other memorabilia, Convention Sales will be open:

<i>Friday</i>	4 pm - 8 pm
<i>Saturday</i>	10 am - 6 pm
<i>Sunday</i>	10 am - 3 pm

## Volunteers (Westchester Ballroom Assembly)

*Lunacon* is run entirely by volunteers ... like you. You are the glue that holds the convention together. Everyone from the Chair on down donates their time out of the goodness of their heart and the desire for ego boo.

Here is your chance to help us make *Lunacon* work even better. We need help in running most areas of the convention. ***We particularly need help Sunday night for the Art Show tear-down and convention move-out.*** Extra time credit will be given to anyone who helps out on Sunday evenings.

Throughout the convention, we will need your help in the Art Show, the Hospitality Suite, Registration, the Masquerade, the Office, Logistics, Member Services, all purpose volunteers — just about everywhere! Volunteers will either be eligible for prizes won in a special prize raffle, open to volunteers *only*, or receive a specially designed t-shirt for working a set number of hours, or possibly both! Get a fun, fascinating and unforgettable look at what goes on behind the scenes at a con. Perhaps you'll be hooked on it as we were.

Before you can work on the convention, you need to sign our Legal Release form. If you are under 18, your parent or legal guardian must also sign. These forms are available at the Volunteer table or in the Office, when the volunteer table is closed.

# Restaurant Guide

What follows does not purport to be an exhaustive list of restaurants, it is intended as a guide to those places where a fan can find a meal without major refinancing. If you remember a favorite locale from when *Lunacon* was at the Westchester Marriott, remember our former venue is only a few miles across the County on Route 119.

Establishments are listed in alphabetical order with the obligatory symbols: food (\*), price (\$), and ambiance (+). One caveat: *Lunacon* is the largest thing to hit these parts in some time and it might be advisable to call ahead to make sure the rest of the convention has not just walked in the door.

**Angsavane**, 163 North Main Street, Port Chester, 937-2727.  
Italian (Thai owner); dinner; Reservations recommended; casual dress;  
\*\*\* \$\$ ++

**Atrium**, Arrowwood, Anderson Hill Road, Rye Brook, 939-5500.  
Primarily Sunday brunch; Reservations required; casual dress;  
\*\*\* \$\$\$ ++

**Bagel Emporium**, Caldor Shopping Center, Port Chester.  
Breakfast, lunch (eat in or take out); \$

**BelPaese**, 44 South Regent Street, Port Chester, 937-2904.  
Italian; dinner; Reservations not required; casual dress; \*\* \$\$ +

**Black Sheep**, 179 Rectory Street, Port Chester, 937-4700.  
Middle American; dinner; Reservations recommended; casual dress;  
\*\* \$\$ ++

**Clino's Pizza, Pasta and Things**, 529 Boston Post Road; Port Chester, 939-8000. Italian, lunch, dinner; Reservations for large parties; casual dress; \*\* \$\$ ++

**Cobble Creek Cafe**, Anderson Hill Road, Purchase, 761-0050.  
Yuppie food; lunch, dinner (closed Sunday); reservations recommended; casual dress (no jeans); \*\*\* \$\$\$ ++

**Cobblestones**, Anderson Hill Road, Purchase, 761-0050.

Family restaurant with bar; lunch, dinner; Reservations not necessary; casual dress; \*\* \$\$ +

**Coyote Flaco**, 115 Midland Street, Port Chester; 937-6969.

South American-Spanish; lunch, dinner; Reservations recommended; casual dress; \*\* \$ +

**Crystal Cafe**, 139 North Main Street, Port Chester, 939-3030.

Chinese; lunch and dinner buffet; Reservations recommended; casual dress; \*\* \$\$ ++

**Davy Byrnes**, 538 Willet Avenue, Port Chester, 937-2106.

Irish pub; lunch, dinner; Reservations accepted; casual dress; \* \$\$ ++

**Frankie Carp's**, 460 North Main Street, Port Chester, 939-1610.

Cajun and Seafood; dinner; Reservations recommended; casual dress; \* \$\$ +

**Garden Plaza**, Washington Park Plaza, Rye Brook, 939-8888.

Middle American; breakfast, lunch, dinner; No reservations; casual dress; \*\* \$ +

**George's Hilltop**, Anderson Hill Road, Purchase, 253-9680.

Middle American food; lunch, dinner; Reservations recommended; casual dress; \*\* \$\$ ++

**Gus's Franklin Park**, 126 Halstead Avenue, Harrison, 835-9804.

Middle American food; lunch, dinner; No reservations; casual dress; \*\* \$\$ ++

**J.B. Coughlin's**, 5 Midland Avenue, Port Chester, 939-9599.

Middle American food; lunch, dinner (closed Sunday); Reservations for large parties; casual dress; \*\* \$ +

**Maine Street Seafood Restaurant**, 454 North Main Street, Port Chester,

939-1610. Seafood; dinner; Reservations recommended; casual dress; \*\*\* \$\$ ++

**Marianacci's**, 24 Sherman Street, Port Chester, 939-3450.  
Italian; lunch, dinner; Reservations not required; casual dress; \*\*\* \$\$ ++

**Marissa's**, 223 Westchester Avenue, Port Chester, 937-6665.  
Italian; lunch, dinner; Reservations recommended; casual dress; \*\* \$\$ +

**Mazel Wok Glatt Kosher**, Shoe-Town Shopping Center, 2700 Central Park Avenue, Yonkers, 472-7579. Kosher Chinese; open one hour after sundown until 1 am Saturday, Sunday 11:30 - 10:30 pm.

**McDonald's**, 321 Boston Post Road, Port Chester, \$

**Oasis**, 23 Main Street, Port Chester, 939-7220.  
Middle American; lunch, dinner; Reservations recommended; casual dress; \*\* \$\$ ++

**P & D Restaurant**, 508 Westchester Avenue, Port Chester, 939-9628.  
Neighborhood Pizza Parlor; casual dress; \*\* \$ +

**Pappa Bear's**, 64 Merritt Street, Port Chester, 939-9628.  
Middle American; lunch, dinner (closed Sunday); Reservations recommended; casual dress; \*\* \$\$ ++

**Pars**, Washington Park Plaza, 275 South Ridge Street, Rye Brook, 937-5770. Middle American Food with Salad Bar; lunch, dinner, Sunday brunch; Reservations suggested for large parties; casual dress; \*\* \$\$ ++

**Pasta Per Te**, 199 South Regent Street, Port Chester, 939-8659.  
Italian; lunch, dinner; Reservations not required; casual dress; \*\* \$ +

**Pastore's**, 400 North Main Street, Port Chester, 937-8449.  
Italian; dinner; Reservations recommended; jacket and tie; \*\* \$\$\$ ++

**Pearl of Atlantic**, Fox Island Road, Port Chester, 939-4227.  
Portuguese and seafood; dinner; Reservations recommended; casual dress; \*\* \$\$ ++

**Penfield's**, Rye Town Hilton.  
Gourmet dinner; Reservations required; jacket and tie; \*\*\* \$\$\$ +++

**Philomena's**, 163 North Main Street, Port Chester, 937-8449.  
Middle American; breakfast, lunch, dinner; Reservations not required;  
casual dress; \*\* \$ +

**Pizza & Brew**, Rye Ridge Shopping Center, Rye Brook, 937-2511.  
Italian chain; lunch, dinner; Reservations not necessary; casual dress;  
\*\* \$\$ +

**Pizza Pasta Pita**, 1295 North Avenue, New Rochelle, 235-7100.  
Kosher; open one hour after sundown until midnight Saturday,  
Sunday 11 am - 9 pm.

**Provare**, Arrowwood, Anderson Hill Road, Rye Brook, 939-4554.  
Italian; dinner; Reservations recommended; casual dress; \*\* \$\$ ++

**Rye Ridge Deli**, Rye Ridge Shopping Center, Rye Brook, 636-4241.  
Kosher-style deli; breakfast, lunch, dinner, Reservations not necessary;  
casual dress; \*\* \$\$ +

**Sawpit Restaurant**, 25 South Regent Street, Port Chester, 939-1360.  
Italian; lunch, dinner; Reservations not necessary; casual dress;  
\*\* \$\$ ++

**Siam Sea Grill**, 134 North Main Street, Port Chester, 939-0477.  
Thai; dinner; Reservations not required; casual dress; \*\* \$\$ +

**Skytop Restaurant**, Westchester County Airport, Harrison, 428-0251  
(overlooks runway). Middle American; lunch, dinner; Reservations  
recommended; casual dress; \* \$\$ ++

**Szechuan Empire II**, 427 Boston Post Road, Port Chester, 937-1876.  
Chinese; lunch, dinner; Reservations recommended; casual dress; \*\* \$ +

**Szechuan Harrison**, 278 Halstead Avenue, Harrison, 835-0880.  
Chinese; lunch, dinner; Reservations not necessary; casual dress;  
\*\* \$\$ ++

**Tulip Tree**, Rye Town Hilton.  
Hotel coffee shop; Reservations recommended during convention, casual  
dress; \*\*\* \$\$ ++

**Willett House**, 20 Willett Avenue, Port Chester, 939-7500.  
Yuppie food; dinner; Reservations not necessary; casual dress; \*\* \$\$ ++



**Woodlands**, Stouffer Westchester Hotel, Harrison, 694-5400.  
Lunch, dinner, Sunday Brunch; Reservations suggested; Casual dress;  
\*\* \$\$\$ ++

---

## Other Area Shopping

Except for the Kosher grocery and gas stations, all of the listed shops are in either the Rye Ridge Shopping Center (RR), or the Washington Park Plaza (WP).

<b>Bakery</b>	Cerbone's, RR, 937-5474
<b>Bank</b>	Bank of New York, RR, ATM
<b>Books</b>	Reader's Market, RR, 937-3370
<b>Candy</b>	Chocolate Plus, RR, 939-0101
<b>Food</b>	Finast, RR, 939-3222 Food Emporium, WP, 937-6900
<b>Gasoline</b>	Exxon, South Ridge Street & Bowman Avenue Mobil, South Ridge Street & Bowman Avenue
<b>Kosher</b>	Scarsdale Kosher Emporium 1066 Wilnot Road, Scarsdale, 835-4700 Friday 8 am-3 pm, closed Saturday, Sunday 8 am-5 pm
<b>Liquor</b>	Florio's Wine & Liquor, RR, 939-2121 Rye Brook Wine & Spirit, WP, 939-7511
<b>Pharmacies</b>	CVS, WP, 937-2301 Finch's Drug Store, RR, 937-4444
<b>Sundries</b>	Woolworth, RR, 939-2621

## *In Memoriam*

Irwin Allen  
Joe Braman  
Frank Capra  
Stacey Davies  
Theodore (Dr.) Seuss Geisel  
E. Dorothea (Doll) Gilliland  
James Irwin  
Jerzy Kosinski  
Fred MacMurray  
Joseph Papp  
Gene Roddenberry  
Isaac Bashevis Singer  
Arkady Strugatsky  
James V. Taurasi

All information in this publication is preliminary, and is subject to change without notice before, during, or after the convention.

*Lunacon '92* Pocket Program is published and ©1992 by the New York Science Fiction Society — the Lunarians, Inc., P.O. Box 338, New York, NY 10150-0338. *Lunacon* is the annual New York Metropolitan Area science fiction convention run by the New York Science Fiction Society — the Lunarians, Inc., a non-profit organization.

Paul Birnbaum - Editor  
Midnight Mechanicals - Final Output  
Printed by Mapleton Printing and Offset Company